

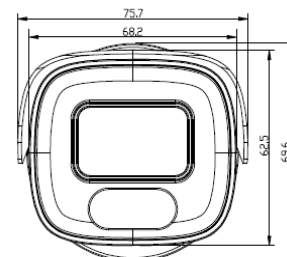

Model No.: ON-E0G-2M 2MP HD Warm Light Metal Bullet Camera

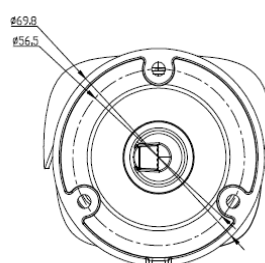
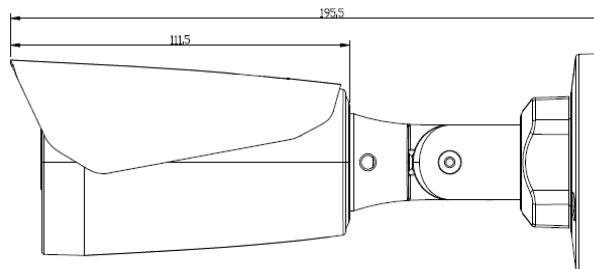

Product Features

2MP HD Analog Out put(AHD/TVI/CVI)

- ▶ 1/2.9" High-Performance Progressive Scan COMS
- ▶ No Delay, Lossless, Long Distance transmission Up to 400 meters
- ▶ Support 4mm Lens
- ▶ Support DNR /DWDR
- ▶ Support low illumination, warm light day night full color
- ▶ Support ICR switch, realize day&night monitor
- ▶ Support OSD Menu/DIP Switch /circulation button switch(Optional)
- ▶ Applicable to the Financial Departments, Telecommunications, Government, schools, airports, factory, Hotels , Museum, Public transportation and Other places.

Parameter Classification	Parameter Name	Parameter Value
Camera	Image Sensor	1/2.9" 2MP Progressive Scan COMS V30H+SC2237
	Resolution	1920*1080
	Image System	PAL/NTSC
	Light ON	0.1 lux @ (F2.1, AGC ON)
	Electronic shutter	PAL: 1/25 s to 1/50,000 s; NTSC: 1/30 s to 1/50,000 s
	Lens	3.6mm
	LEDs	2 PCS 3500K soft warm light
	SNR	>52dB (AGC off)
	Full color distance	15m
	Video Frame Rate	1080P@25fps, 1080P@30fps
	Video Output	TVI/AHD/CVI/ CVBS
Menu	D&N	Support Color/ BW
	DNR	Support 2D 3D NR
	WDR	DWDR
	Smart LED	Support Auto/Manual Model · 1-10 level adjust
	White Balance	ATW / MWB/GRAY WORLD
	BLC	Support

	Image set	contrast、sharpness、saturate、3DNR、2DNR、DWDR
	Language	English, Chinese
General	Power Supply	12VDC \pm 10 %;
	Operating Conditions	(-20° C to 60° C), Humidity 90% or less (non-condensing)
	Protection level	IP66
	Power Consumption	Max. 3W (Max. 3W with LED ON)
	Dimensions	195.5mm*69.6mm*69.6mm