

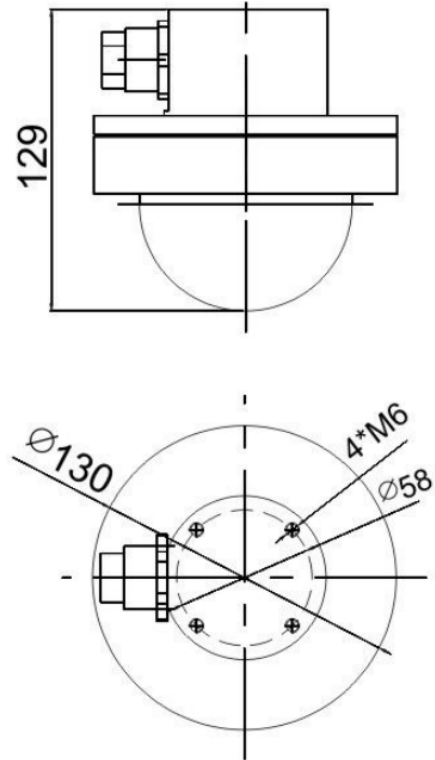

Model : **ON-EXAD01-2M**

## 2MP AHD Mini Fixed Dome Camera (316L Stainless Steel Explosion Proof)



### Application Environments

Applicable for the factories having the explosive mixtures formed from class IIA,IIB and IIC T1-T6 group flammable gas, steam with air in area No.1 , No.2, and appearing the explosive hazardous area due to the mixture of flammable dust and air in area No.20,No.21 and No.22,such as oil field, chemical plant, port, oil storage, steamship, oil drilling platform, gas stations, coal mine, aviation, military, medicine, steel, firecrackers production, machinery, food processing and storage and so on.

### Features

- Small volume, light weight, flexible installation.
- The fourth generation newest broad dynamic technology, dynamic range greater than 75dB, effects increase obviously
- 5m-15m visible infrared distance, high quality image showed even in badly lighting areas.
- Process the original signal through 3D digital noise reduction technology so as to make crisp, bright pictures at night.
- Automatic IR CUT conversion day and night, high quality pictures with clear vivid colors, sync infrared lights keep the pictures excellent at night.
- Aviation high strength polycarbonate explosion-proof half dome housing, flux rate higher than 93%.
- 316L stainless steel with original color surface treatment, corrosion-proof.

## Technical Parameter

Model		ON-EXAD01-2M
<b>Certificate of Conformity</b>		
Marking		Ex d II C T6 Gb/EX tD A21 IP68 T80℃
Cer.No.		CNEx18.3722X
<b>Mechanical Features</b>		
Material		316L Stainless Steel
Surface Treatment		Original Stainless Steel Color Electropolishing Optional
Ingress Protection		IP68
Horizontal Manual Adjustable Range		360°
Vertical Manual Adjustable Range		±45°
Interface Spec		G-1/2"
Weight		≤2kg 【Stainless Steel】
Method of Installation		Ceiling Type & Column Mounting & Wall Mounting
<b>Electrical Features</b>		
Power Supply		DC12V
Camera	Image Sensor	AHD(1080P) SONY IMX323+2441H
	Resolution	1080P
	Lens	4mm
	Signal-to-Noise Ratio	>75db
Infrared	Distance	5-15m
	Wavelength	850nm
<b>Environmental</b>		
Rated Temperature		(-30℃, +70℃)
Atmospheric Pressure		80-106KPa
Relative Humidity		≤95%RH(+25℃)