

# **ON-FB347IZ-V4** 4MP 4 in 1 IR Bullet Camera

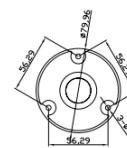
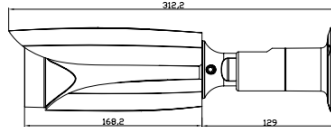
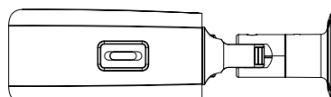
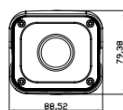

|                              |  |
|------------------------------|--|
| <b>Model No.</b>             | <b>ON-FB347IZ-V4</b>                                       |
| <b>Image Device</b>          | 1/3" 4MP CMOS(OV4689+FH8538M)                              |
| <b>Horizontal Resolution</b> | 4.0 Mega Pixels  |
| <b>Effective Pixels</b>      | 2688H x 1520V  |
| <b>Electronic Shutter</b>    | 1/25(1/30)~1/5,0000sec                                     |
| <b>Image System</b>          | PAL/ NTSC  |
| <b>Synchronization</b>       | Internal   |
| <b>S/N</b>                   | More than 50dB (AGC off)                                   |
| <b>Mini. Illumination</b>    | 0.05Lux(F1.2,AGC ON),0 Lux with IR ON                      |
| <b>Video Standard</b>        | AHD  |
| <b>Video Output</b>          | AHD/TVI/CVI/CVBS   |
| <b>Menu</b>                  |  |
| <b>OSD Menu</b>              | OSD Cable optional / UTC Coaxial Control (via DVR) support |
| <b>Noise Reduction</b>       | 2D_DNR   |
| <b>BLC</b>                   | OFF/HSBLC/BLC  |
| <b>AGC</b>                   | 0-15 Level   |
| <b>White Balance</b>         | ATW/AWC-SET/Indoor/Outdoor/Manual/AWB                      |
| <b>Flicker less</b>          | PAL: 25Hz / NTSC: 30Hz                                     |
| <b>DEFOG</b>                 | OFF/AUTO   |
| <b>D-WDR</b>                 | ON/OFF   |
| <b>SENSE-UP</b>              | ON/OFF   |
| <b>Motion Detection</b>      | OFF/ON(4 AREAS)  |
| <b>Feature</b>               |  |
| <b>Max. IR LEDs Length</b>   | 4pcs Array Leds , 40M , Smart IR                           |
| <b>Day/Night</b>             | IR Cut Filter Auto Switch                                  |
| <b>Focal Length Lens</b>     | 3.6mm Mega Pixel Lens                                      |
| <b>Mount Type</b>            | M14  |
| <b>General</b>               |  |
| <b>Power Supply</b>          | DC12V±10%  |
| <b>Working Environment</b>   | -10°C~+50°C, Humidity 10%-90%                              |
| <b>External Protection</b>   | IP66 Grade (waterproof IP66)                               |
| <b>Power Consumption</b>     | 450mA  |
| <b>Transmission Distance</b> | Over 500m via 75-3 coaxial cable                           |
| <b>Ingress Protection</b>    | Metal Bullet   |