

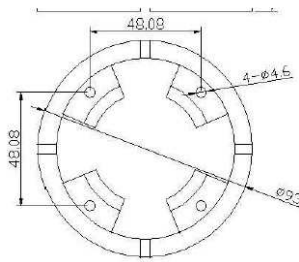

ON-ND62A-S6 2MP 4 in 1 IR Dome Camera

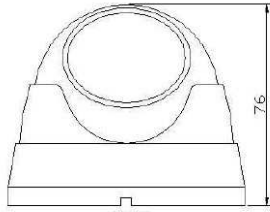

Model	ON-ND62A-S6
Sensor	1/2.9" 2Mega Pixel CMOS(IMX323+NVP2441)
Signal Mode	PAL/NTSC
Effective Pixel	1920H*1080V
Noise Reduction	2D/3D
Day/Night	Auto(ICR)/Color/Black
Min. Illumination	0.05 Lux/F1.2
S/N Ratio	≧ 50dB
Electronic Shutter	1/25s~1/45,000s
Lens	3.6mm
LED	24Pcs IR LED
Infrared Distance	20M
Video Standard	Comply with AHD/TVI/CVI
Video Output	AHD/TVI/CVI/CVBS
Max.Transfer distance	Normal 75-5 coaxial cable up to 500m
OSD Menu	Optional
Working Temperature	-10°C ~ +50°C , Less than 95%RH (No condensation)
Power	DC12V±10 %