

Wireless push button & access for automatic doors

ON-PB188

Ver19.1

● Features

- Adjustable releasing timer by VR. **0.5~6 Sec.** (Default: 0.5 Sec.)
- Dapper appearance with anti-off screw.
- With large capacity output, available to be used with autodoor, electric lock and access controller.
- Easy to install with no wiring.
- Learning code type, one access can match **40 pieces** push buttons.
- Optional transmitter. (ON-201DF / ON-P601)

● Specification

Wireless access for automatic doors(ON-PB188R)	
Power input	AC 100V~240V
Standby current	25mA±5%
Operating current	45mA±5%
Relay contact capacity	AC125V 0.5A / DC30V 1A
Wireless push button(ON-PB188T)	
Power supply	DC 3.3V, 2 pcs battery (CR2032)
Emission current	2.6mA / times
Life of battery	200 times / day, 300 days
Transmit distance	Max.12m(Depending on the environment)

● Appearance



● Optional transmitter

ON-201DF	ON-P601
<p>65 / 2.6</p> <p>36 / 1.4</p> <p>mm / inch</p>	<p>51 / 2.0</p> <p>31 / 1.2</p> <p>Blue LED Button</p>

Wireless push button
(ON-PB188T)

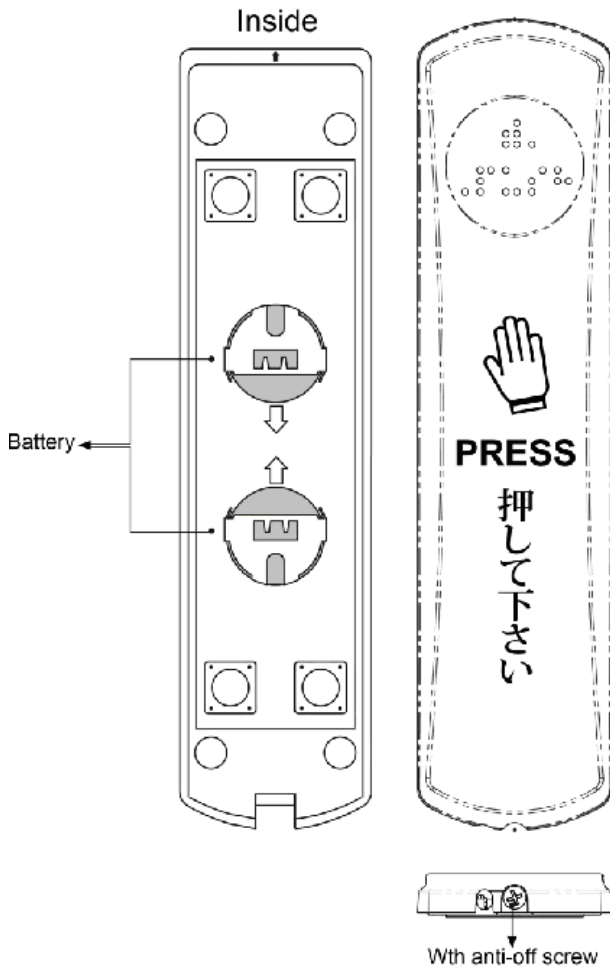

Wireless access for automatic doors
(ON-PB188R)

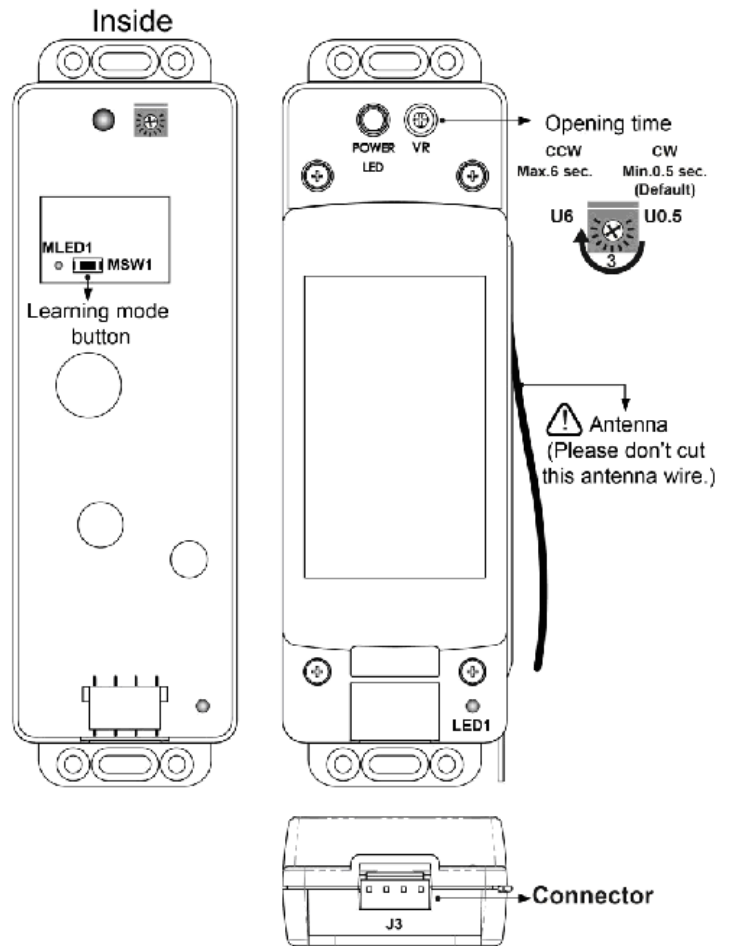

● The procedure of adding / deleting push button (transmitter)

Add

Step: Pressing the learning mode button(MSW1) on the PCB(ON-PB188R), the Red LED(MLED1) will light, then press the push button and Red LED(MLED1) will flash(Continue press other push button). After add all push button, cut off the power supply from ON-PB188R for 3 seconds, then turn on power. Press push button then Green LED(LED1) will light, setting success.

Delete

Step: Pressing the learning mode button(MSW1) until the Red LED(MLED1)off, all push buttons have been deleted from memory.

● Wire configuration

Pin	Color	Function
1	Blue	AC100V~240V Power input
2	Blue	
3	Yellow	COM.
4	Green	NO.

● Dimension: Unit(mm / inch)

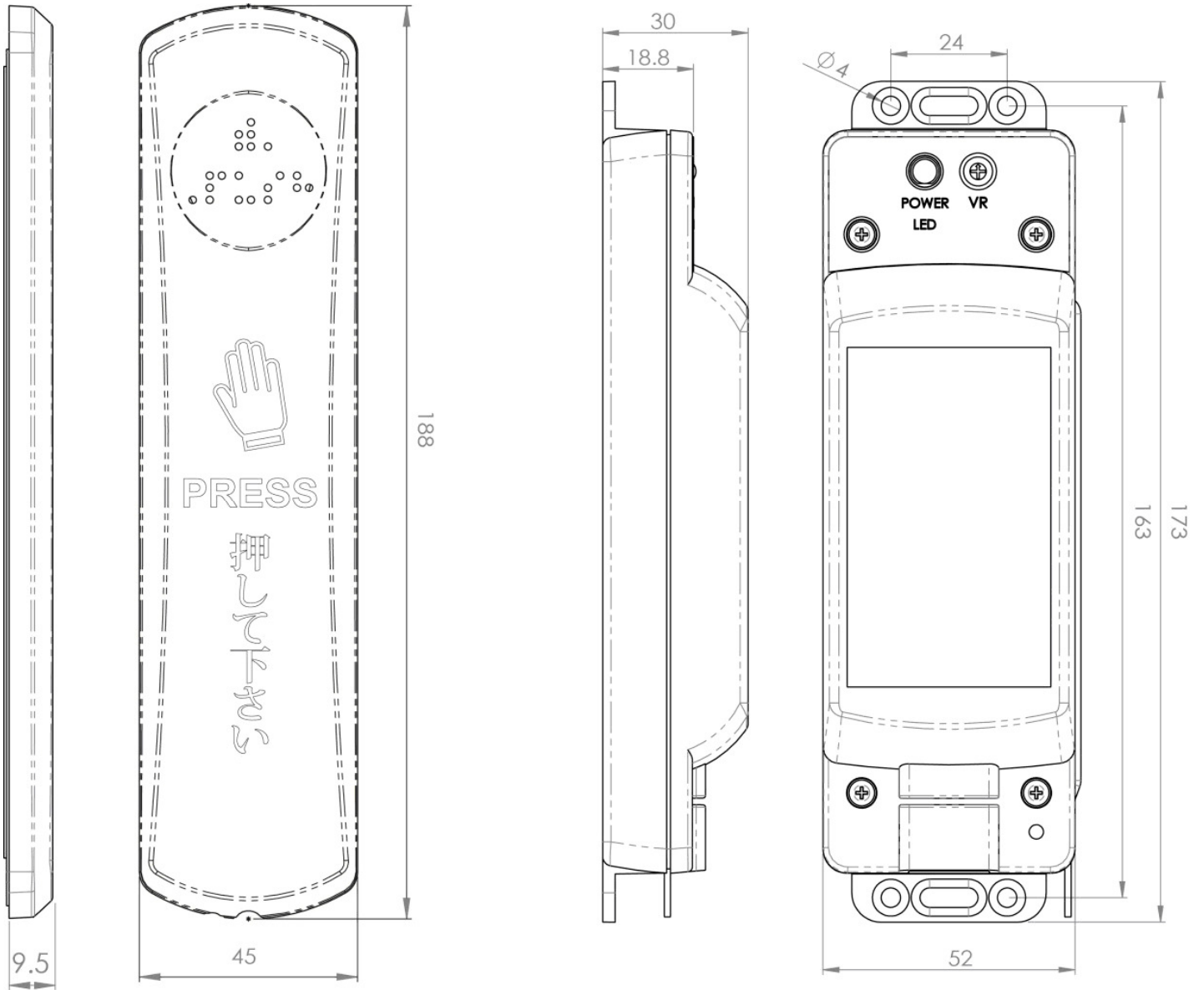

* Specifications subject to change without notice for further modification.