

1 Open your "Network Connections"

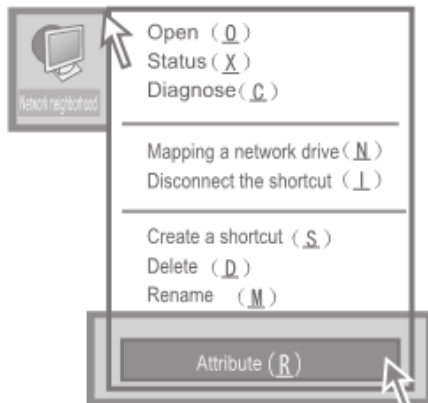

2 Open your "Local Area Connections", and choose "Property" .

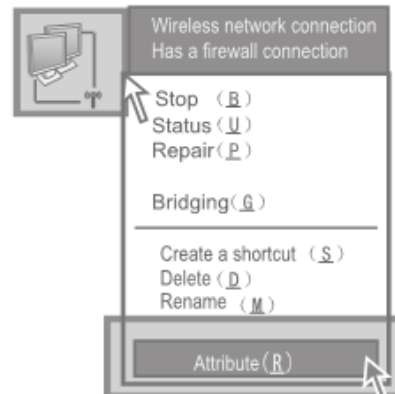

3 Double click "Internet Protocol (TCP/IP) Properties".

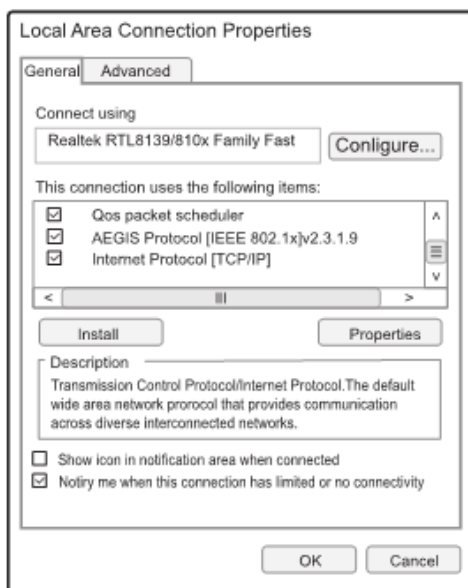

4 Set your IP to "Use the following IP address"

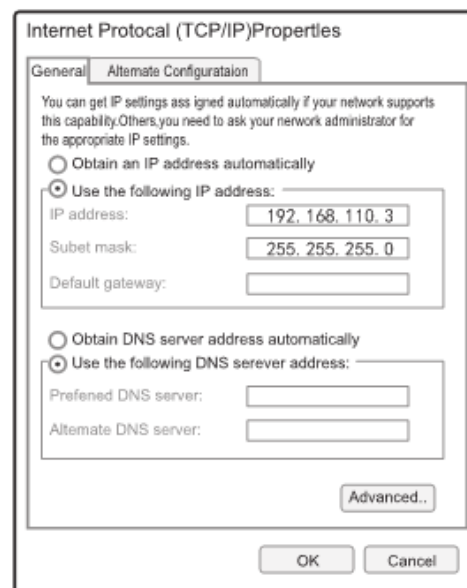

- 5** Open your IE and enter in "192.168.110.1", the password is "password" enter in the password "password"

Wireless Network

Easy Setup

Status

Connection

Firewall

System

Logut

Login

Enter admin password:

Login

Current Date & Time

02/24/14 03:53 UTC

- 6** Get into the firmware.and choose"Easy Setup"
(choose the Mode which you need)

Wireless Network

Easy Setup

- Easy Setup
- ADSL
- AP
- Terminal
- Repeater
- AP+WDS
- Terminal(WDS)
- Repeater(WDS)

Status

Connection

Firewall

System

Logut

Working Mode

ADSL(Provide ADSLdialing service from network operators-Auto Dialer for PPPOE)

AP(Turn wired signal to wireless wifi signal-wifi sending)

Terminal(Turn wireless signal to wifed signal-wifi receiving)

Repeater(Receiving and sending wireless signal-wifi amplifier)

AP+WDS(Turn wired signal to wireless wifi signal-wifi sending(WDS))

WDS Terminal(Turn wireless signal to wifed signal-wifi receiving(WDS))

WDS Repeater(Receiving and sending wireless signal-wifi amplifier(WDS))

Easy Setup

- ▶ Easy Setup
- ADSL
- AP
- Terminal
- Repeater
- AP+WDS
- Terminal(WDS)
- Repeater(WDS)

Status

Connection

Firewall

System

Logout

Working Mode

ADSL(Provide ADSL dialing service from network operators-Auto Dialer for PPPoE)

AP(Turn wired signal to wireless wifi signal-wifi sending)

Terminal(Turn wireless signal to wired signal-wifi receiving)

Repeater(Receiving and sending wireless signal-wifi amplifier)

AP+WDS(Turn wired signal to wireless wifi signal-wifi sending (WDS))

WDS Terminal(Turn wireless signal to wired signal-wifi receiving(WDS))

WDS Repeater(Receiving and sending wireless signal-wifi amplifier(WDS))



Transmitter: (Connect to the NVR side)

Wireless Network

Easy Setup
Easy Setup
ADSL
AP
Terminal
Repeater
▶ AP+WDS
Terminal(WDS)
Repeater(WDS)

Status

Connection

Firewall

System

Logout

Internet / WAN

Current IP: Renew Lease Now

Current Lease Expires:

Wan Ethernet Port: Normal Use ▼

Local Network / LAN

Router IP: 192.168.110.1

Wireless

Operation Mode: N+A ▼

Channel Width: 40MHz (2nd chan. below) ▼

Transmit Power: Max ▼ 27 (0 - 27dBm)

Wireless MAC Filter:

Access Point SSID: WiFi

Wireless Channel: 5200MHz[40] ▼

Encryption: None ▼

Clients Quantity:

Save Changes > Reset >

Access Point SSID: WiFi

Wireless Channel: 5200MHz[40]

Encryption:

Clients Quantity:

Save Changes > Reset

- 5200MHz[40]
- 5220MHz[44]
- 5240MHz[48]
- 5765MHz[153]
- 5785MHz[157]
- 5805MHz[161]
- 5825MHz[165]
- 4940MHz
- 4960MHz
- 4980MHz
- 5000MHz
- 5020MHz
- 5040MHz
- 5060MHz
- 5080MHz
- 5100MHz
- 5120MHz
- 5140MHz
- 5160MHz
- 5845MHz

Status

Connection

- Basic
- Authentication
- ▶ DHCP
- Dynamic DNS
- Routing
- Wake on LAN

Firewall

System

Logut

DHCP

LAN DHCP Server Enabled

DHCP range :

Start : 192.168.110.

End : 192.168.110.

Lease Time : (hours)

Static IPs

Block MAC addresses assigned a static IP that connect from a different IP

Add Static IP Addresses :

Hostname (optional)	MAC	IP	
<input type="text"/>	<input type="text"/>	<input type="text"/>	<input type="button" value="Add"/>

Select Hostname/MAC From Currently Connected Hosts ▼

Assigned Static IP Addresses :

Save Changes Reset

Receiver: (Connect to the camera side)

The screenshot displays a network configuration interface with a sidebar on the left and a main content area on the right. The sidebar contains the following menu items: Easy Setup (with a right-pointing arrow), ADSL, AP, Terminal, Repeater, AP+WDS, Terminal(WDS), and Repeater(WDS). Below these are sections for Status, Connection, Firewall, System, and Logout. The main content area has a header 'Wireless Network' and a section titled 'Working Mode' containing a list of modes: ADSL(Provide ADSL dialing service from network operators-Auto Dialer for PPPoE), AP(Turn wired signal to wireless wifi signal-wifi sending), Terminal(Turn wireless signal to wired signal-wifi receiving), Repeater(Receiving and sending wireless signal-wifi amplifier), AP+WDS(Turn wired signal to wireless wifi signal-wifi sending (WDS)), WDS Terminal(Turn wireless signal to wired signal-wifi receiving(WDS)), and WDS Repeater(Receiving and sending wireless signal-wifi amplifier(WDS)). The 'WDS Terminal' option is highlighted with a red rectangular border, and a red arrow points to it from the right.

Wireless Network

Easy Setup

- ▶ Easy Setup
- ADSL
- AP
- Terminal
- Repeater
- AP+WDS
- Terminal(WDS)
- Repeater(WDS)

Status

Connection

Firewall

System

Logout

Working Mode

- ADSL(Provide ADSL dialing service from network operators-Auto Dialer for PPPoE)
- AP(Turn wired signal to wireless wifi signal-wifi sending)
- Terminal(Turn wireless signal to wired signal-wifi receiving)
- Repeater(Receiving and sending wireless signal-wifi amplifier)
- AP+WDS(Turn wired signal to wireless wifi signal-wifi sending (WDS))
- WDS Terminal(Turn wireless signal to wired signal-wifi receiving(WDS))**
- WDS Repeater(Receiving and sending wireless signal-wifi amplifier(WDS))

Easy Setup

- Easy Setup
- ADSL
- AP
- Terminal
- Repeater
- AP+WDS
- Terminal(WDS)
- Repeater(WDS)

Status

Connection

Firewall

System

Logout

Wireless Bridge/Repeater

Bridge IP: (must be in AP subnet)

Subnet Mask: (same as AP mask)

AP/Gateway IP:

Wan Ethernet Port:

DNS Servers:

Connect Via WDS

Operation Mode:

Channel Width:

Transmit Power: (0 - 27dBm)

SSID to Join:

MAC Binding(Blank if not binding):

Wireless Channel:

Encryption:

The wireless channel of the receiver should be the same with the transmitter. (Such as 5200MHz)

The password should be also the same.

Save changes to take effect after automatic restart.