

# Home Robot camera Quick Manual

## Operation

### 1. Download APP

Ways one: Scan QR code.



iCSee

Tips two: Search "iCSee" in the App store or Googleplay and download.

### 2. Power on

Install TF Card, Then power on.

## 3. Camera configuration

### ★ User login

01. open the app " iCSee", choose the " login" (picture 1) (If without user name, please register first).

02. After Click " + " ( picture 2).

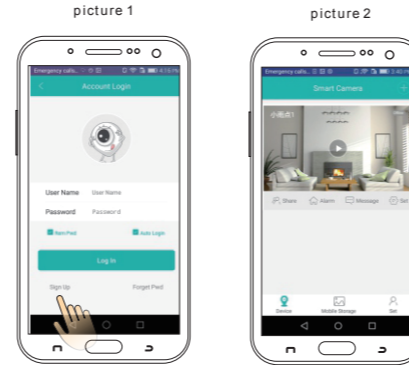

03. Enter to " Add device " (picture 3), please input WiFi router password (picture 4), Then confirm.

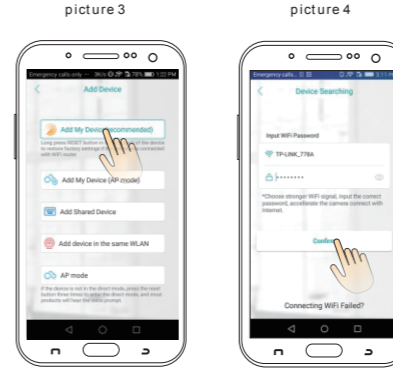

04. After you hear a camera voice " connect successfully ", will enter to " set pwd " Then confirm (picture 5).

05. After " confirm " will enter to " pick a name " (picture 6).

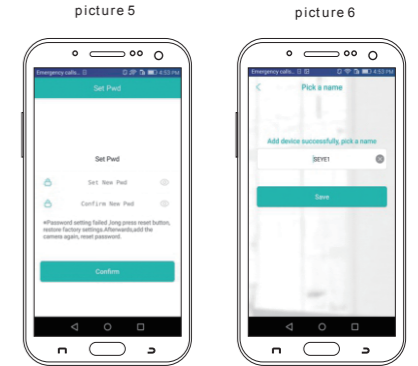

06. After click " save " will enter to video (picture 7).

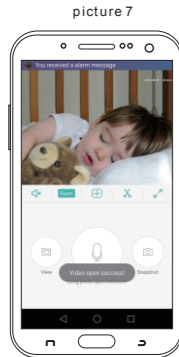

### ★ Temporary user

Don't need register. Add the device then check video. (The information only kept in your mobile phone. If you change the mobile phone, must restart download the app and add device. This model don't support alarm push).

- Open App " iCSee ", choose temporary visit.



- click the upper right " + ", according to promote tips, finish add camera.
- Please refer to the "User model-02/03" introduce operation.

## FAQ

Q: How to store a video camera?  
A: Currently, the Home Robot camera supports FAT32G format Class6, Class10 TF Card, max supports 128G. When the TF Card is full, it will delete earlier video automatically and loop recording.

Q: The camera be offline, how to do?  
A: Check the power and wifi.  
Restart power on and restart the camera.  
Reconfigure the camera.  
Check the home broadband network.

Q: How to switch network environment?  
A: When using in the new network environment, please long press the reset button (SET) for 6 seconds release the button. It means that restored to factory setting successfully. Then you can start to connect network configuration again.

## Directions

App and device firmware will have new update irregularly, you could upgrade it online at app setting, instructions are for reference only.

### ⚠ Notice

While using this product, please modify the user password, to avoid the delinquents misappropriation.

Do not install the equipment in damp, dusty, children easy access to the venue.

Please allow within the scope of use and storage of temperature and humidity, do not disassemble it at will.

## Warranty Card

Product Name		Model	
Purchase Date		Purchase Store	
Cause			
Process			
Customer Name		Customer Gender	
Customer Phone		ZIP	
Address			

Warranty period: one year.  
This warranty card is only our company's products.