

(3) Power On/Off: Press the switch button on the right side of the device. (Fig.12)

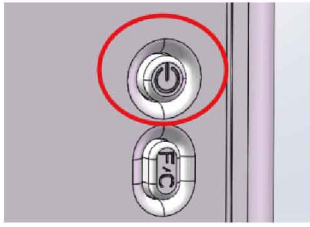

(Fig. 12)

### Warnings

1. Do not pour hand sanitizer into Temperature Measuring Probe and Proximity Sensor.
2. Make sure that it is standing upright after filling in hand sanitizer.



# Intelligent Sensor Soap Dispenser

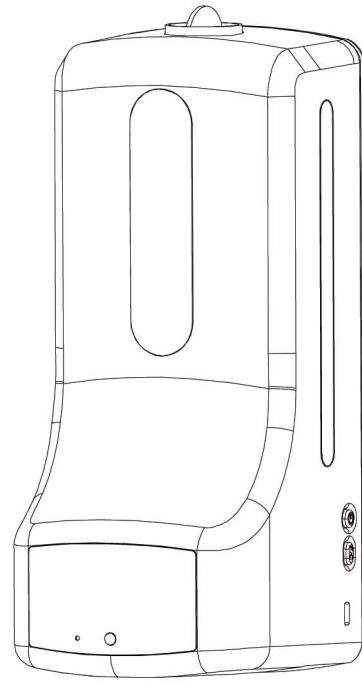

### Appearance

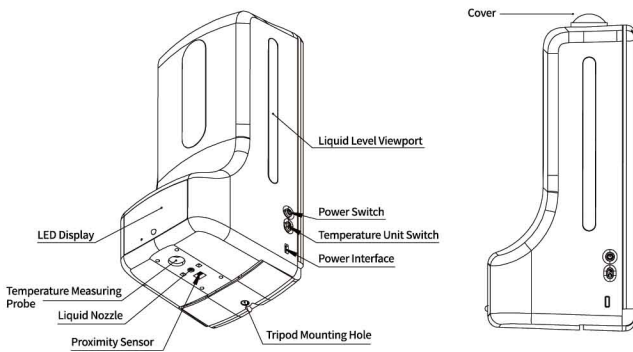

### Specification

1. Accuracy:  $\pm 0.2^{\circ}\text{C}$  (34-45 $^{\circ}\text{C}$ ZZ, put it in the operating environment for 30 minutes before use)
2. Alarm type: flashing + beeping "DIDIDI"
3. Measuring distance: 5cm-10cm
4. LED display: Number
5. Interface: USB Type-C Port
6. Bottle Capacity: 1000mL
7. Mounting Type: Wall-hanging, Tripod-fixed
8. Working Temperature: 10 $^{\circ}\text{C}$ -40 $^{\circ}\text{C}$  ( 15 $^{\circ}\text{C}$ -35 $^{\circ}\text{C}$  Recommended)
9. Measuring range: 0-50 $^{\circ}\text{C}$
10. Response time: 500ms
11. Standby time: 5s for non-working, dynamic loop with white light
12. Input: DC 5V 1500MA
13. Dimension: 119\*133\*280mm
14. Liquid type: hand sanitizer

### Conditions

1. Standby: the white dot on the bottom of right corner flashing by turns. (Fig. 1)



(Fig.1)

2. Normal temperature: displays current temperature and green light flashes once on the display. (Fig. 2)



(Fig. 2)

3. Abnormal temperature: displays current temperature and red light flashes on the display. (Fig. 3)



(Fig. 3)

4. Out of measuring range: "Lo": Ultra-low temperature alarm. (Fig. 4); "Hi": Ultra-high temperature alarm. (Fig. 5)



(Fig. 4)



(Fig. 5)

### Instructions

1. Temperature measuring and hand washing: Put your hand on the bottom until you hear a "DI" sound, then the LED screen will display the temperature and hand sanitizer squeezed out. (Fig. 6)

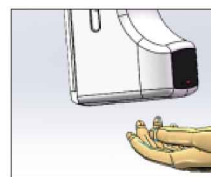

(Fig. 6)

2. Temperature unit switch: Press C/F button on the right side of the device. (Fig. 7), the LED screen will display C or F, C:centigrade, F: Fahrenheit. (Fig. 8 and Fig. 9)

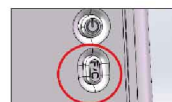

(Fig. 7)



(Fig. 8)



(Fig. 9)

### Mounting

- (1) Tripod mounting: There is screw connection on the bottom which can be connected with tripod. (Fig. 10)

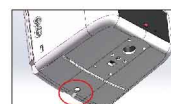

(Fig. 10)

- (2) Wall-hanging: There are two handing holes on the back side can be fixed with nail. (Fig. 11)

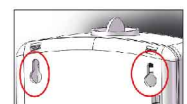

(Fig. 11)